

### REPLACEMENT PARTS

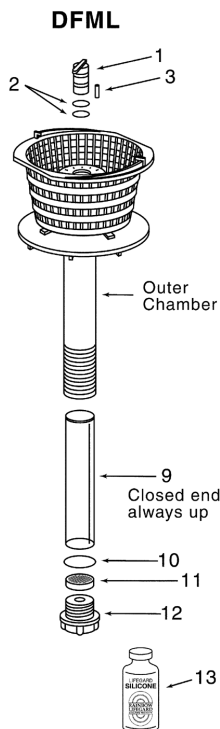
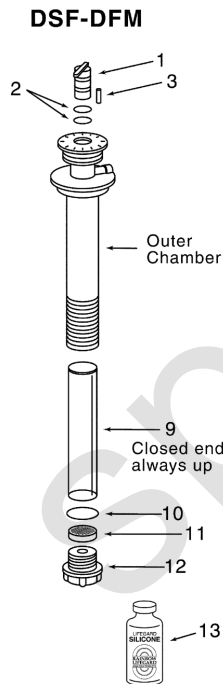
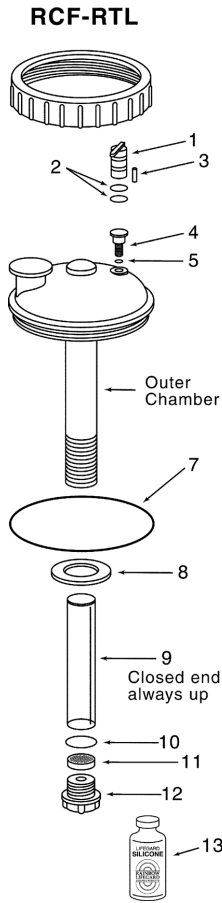

Item	Part No.	Qty.	Description
<b>CHLORINE/BROMINE DISPENSER (R172540/R172540F FOR RCF-RTL)</b>			

1	R172399	1	Control valve stem
2	R33017	2	O-ring, control valve
3	R18854	1	Stop pin
4	R172224X	1	Air vent valve
5	R172221	1	O-ring for air vent valve
6	R172400	1	Inlet screen <sup>1</sup>
7	R172223	1	O-ring lid to housing
8	R172222	1	Gasket, cartridge
9	R172457	1	Replacement inner chamber
10	R172451	1	O-ring, check valve
11	R172401	1	Screen, check valve <sup>1</sup>
12	R172406	1	Check valve assembly
13	R172036	Opt.	Silicone lubricant

<b>CHLORINE/BROMINE DISPENSER (R172560 FOR DSF-DFM)</b>			
---	--	--	--

1	R172399	1	Control valve stem
2	R33017	2	O-ring, control valve
3	R18854	1	Stop pin
6	R172400	1	Inlet screen <sup>1</sup>
9	R172457	1	Replacement inner chamber
10	R172451	1	O-ring, check valve
11	R172401	1	Screen, check valve <sup>1</sup>
12	R172406	1	Check valve assembly
13	R172036	Opt.	Silicone lubricant

<b>CHLORINE/BROMINE DISPENSER WITH BASKET (R172662 FOR DFML)</b>			
--	--	--	--

1	R172399	1	Control valve stem
2	R33017	2	O-ring, control valve
3	R18854	1	Stop pin
6	R172400	1	Inlet screen <sup>1</sup>
9	R172457	1	Replacement inner chamber
10	R172451	1	O-ring, check valve
11	R172401	1	Screen, check valve <sup>1</sup>
12	R172406	1	Check valve assembly
13	R172036	Opt.	Silicone lubricant

<sup>1</sup> Item No. 6 and No. 11 screens are snapped into place and can easily be removed for cleaning or replacement.